



212 W. Ninth Street • Tyler, Texas 75701 • (903) 597-6606

P.T. Cole Park

Addendum #1

Tuesday, October 25, 2022

TO: ALL HOLDERS OF CONSTRUCTION DOCUMENTS & CONTRACT DOCUMENTS

Your attention is directed to the following interpretations of, changes in, and additions to Contract Specifications for the P.T. Cole Park.

1. The last day for questions will be **October 31, 2022 at 12pm.**
2. Sheet C3 - Half basketball court moved from Future Phase and included in project scope as regular bid item. All court details, surfacing, fencing, and equipment to be the same as the other proposed half court and match all existing details. Sidewalk to half court moved from Future Phase and revised to meet ADA standards.
3. Sheet C6 – Site grading for half basketball court and sidewalk. Adjusted quantities in earthwork summary.
4. Sheet C11 – Paving and scoring adjustments to included additional half basketball court and sidewalk.
5. Bid Form – 4” Concrete Pavement increased to 10,121 SF. 6” Concrete Pavement increased to 6,240 SF. Basketball Court Plexipave surfacing increased to 4,200 SF. Additional purchase and install of Goalsetter basketball goal. 10’ tall Chainlink Fencing increased to 120 LF

END OF ADDENDUM

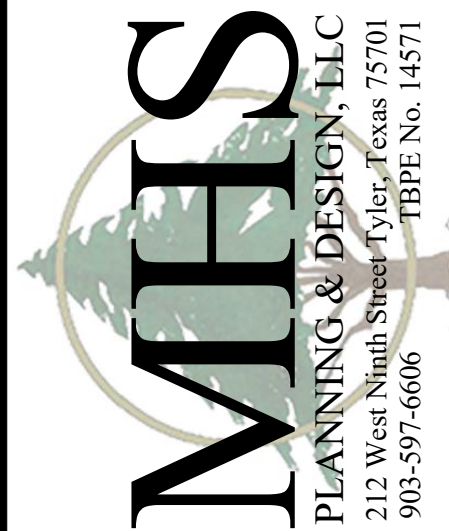
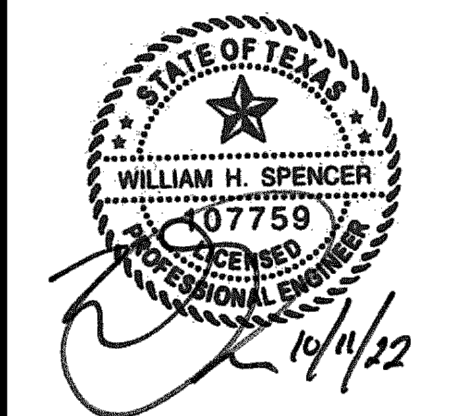

SITE PLAN
P.T. COLE PARK
 CITY OF TYLER, TEXAS

DRAWN: JHD
 CHECKED: WHS
 DATE: 10/25/2022
 SCALE: AS SHOWN
 JOB NO.: 22-069

C3

- ADD ALTERNATES:
 1. SPRAYGROUND SHADE STRUCTURE
 2. ADDITIONAL PLAYGROUND ELEMENTS
 3. FENCE IMPROVEMENTS
- FUTURE PHASE:
 1. PARKING WITH ADA SPACE, RAMP AND SIGN
 2. STORAGE SHED
 3. ART PIECE
 4. ARTISTIC BENCH

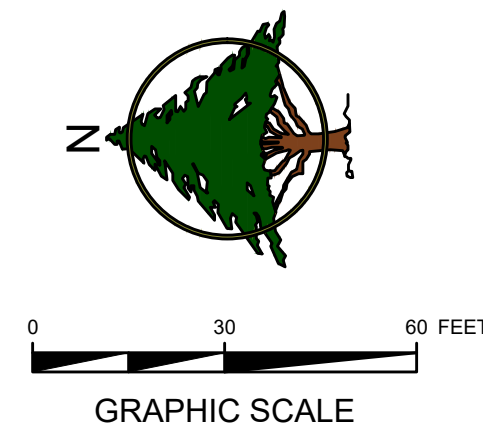

LEGEND

- PROPERTY LINE
- WATER LINE
- SS SANITARY SEWER PIPE
- STM STORM SEWER PIPE
- OHE OVERHEAD ELECTRIC
- UGE UNDERGROUND ELECTRIC & TELECOMMUNICATION
- 6" ASPHALT PAVEMENT
- 4" CONCRETE SIDEWALK
- PLAYGROUND
- SPRAYGROUND
- BASKETBALL COURT
- EXISTING TREES

TREE TABLE

Point	Size	Type
1	24"	Live Oak
2	36"	Post Oak
3	8"	Red Bud
4	54"	Water Oak
5	10"	Chinese Pistache
6	18"	Sycamore
7	20"	Sycamore
8	18"	Chinquapin Oak
9	26"	Sycamore
10	15"	Pin Oak
11	24"	Water Oak
12	15"	Water Oak
13	15"	Water Oak
14	18"	Pin Oak
15	48"	Pin Oak
16	14"	Burch
17	12"	Chinese Pistache
18	50"	Live Oak
19	10"	Chinese Pistache
20	12"	Pecan
21	8"	Chinese Pistache
22	14"	Pecan
23	38"	Pin Oak
24	36"	Water Oak
25	10"	Chinese Pistache
26	42"	Water Oak
27	15"	Water Oak
28	42"	Hackberry

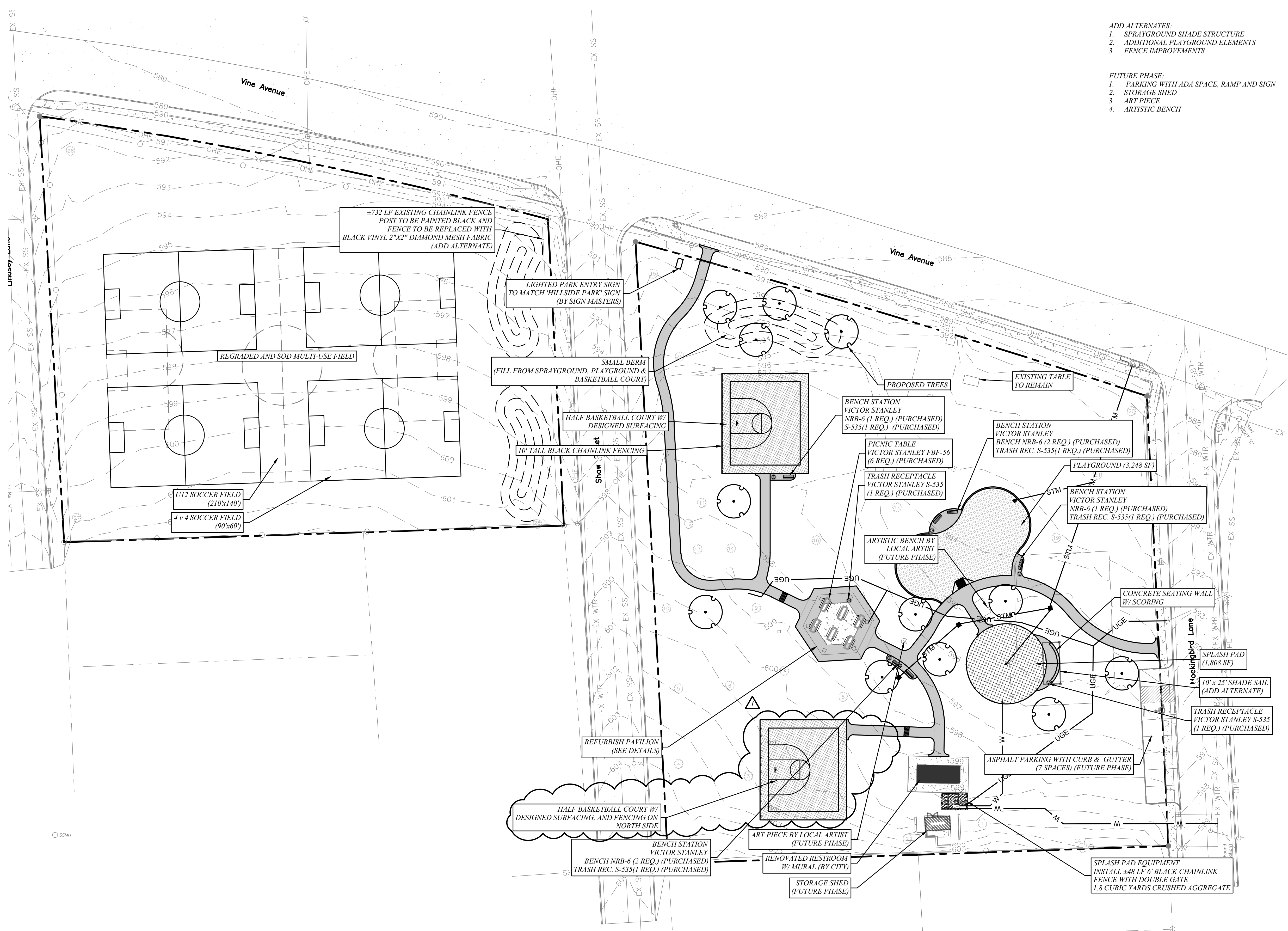

CONTROL POINT TABLE

Control Point	Northing	Easting	Elev.	Description
CP 1	6820826.188	2953768.974	598.399	1/2" IRS "Red Cap"
CP 5	6820835.552	2954073.795	587.416	1/2" IRS "Red Cap"
CP 9A	6820117.314	2953758.925	590.712	1/2" IRS "Red Cap"
CP 10A	6820478.568	2954004.487	589.279	1/2" IRS "Red Cap"
CP 11A	6820466.498	2953576.626	604.476	1/2" IRS "Red Cap"
CP 12A	6820108.670	2953572.794	598.366	1/2" IRS "Red Cap"
COT BM # T-090	6820485.929	2953904.593	591.037	City of Tyler Benchmark



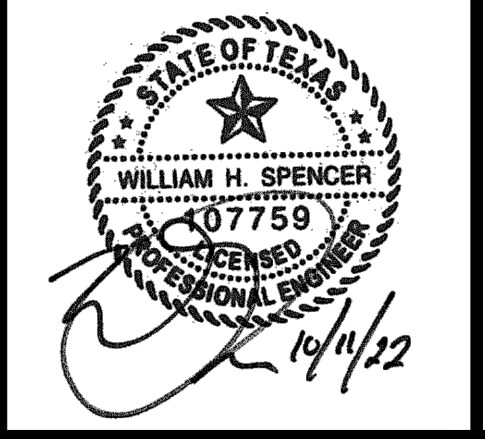

GRADING PLAN I

P.T. COLE PARK

CITY OF TYLER, TEXAS

DRAWN: NSR
 CHECKED: WHS
 DATE: 10/25/2022
 SCALE: AS SHOWN
 JOB NO.: 22-069

C6

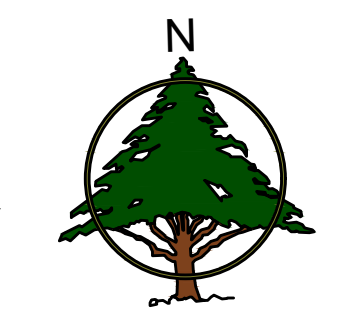

LEGEND

- 500 - EXISTING CONTOUR
- 500 - PROPOSED CONTOUR
- - - DIRECTION OF FLOW
- - - FLOW ARROW
- 528.2(ex) - EXISTING SPOT ELEVATION
- 525.8 - PROPOSED SPOT ELEVATION
- TP = 521.2 - TP = TOP OF PAVEMENT
- BC = 526.6 - BC = BACK OF CURB
- FL = 521.2 - FL = FLOW LINE
- TW = 524.7 - TW = TOP OF WALL
- BW = 523.7 - BW = BOTTOM OF WALL
- TI = 523.7 - TI = TOP OF INLET

EARTHWORK SUMMARY

SURFACE CALCULATIONS:

SOUTH TRACT (PLAYGROUND)
 CUT = 695 C.Y.
 FILL = 1,050 C.Y.
 NET = 985 C.Y. <-FILL>

NORTH TRACT (SOCCER FIELDS)
 CUT = 1,763 C.Y.
 FILL = 358 C.Y.
 NET = 1,405 C.Y. <-CUT>

TOTAL SITE
 CUT = 2,458 C.Y.
 FILL = 1,408 C.Y.
 NET = 1,050 C.Y. <-CUT>

NOTE:
 SURFACE CALCULATIONS ARE BASED ON THE DIFFERENCE BETWEEN TOP OF FINISHED GRADE & EXISTING GROUND. ALL EARTHWORK QUANTITIES ARE APPROXIMATE.

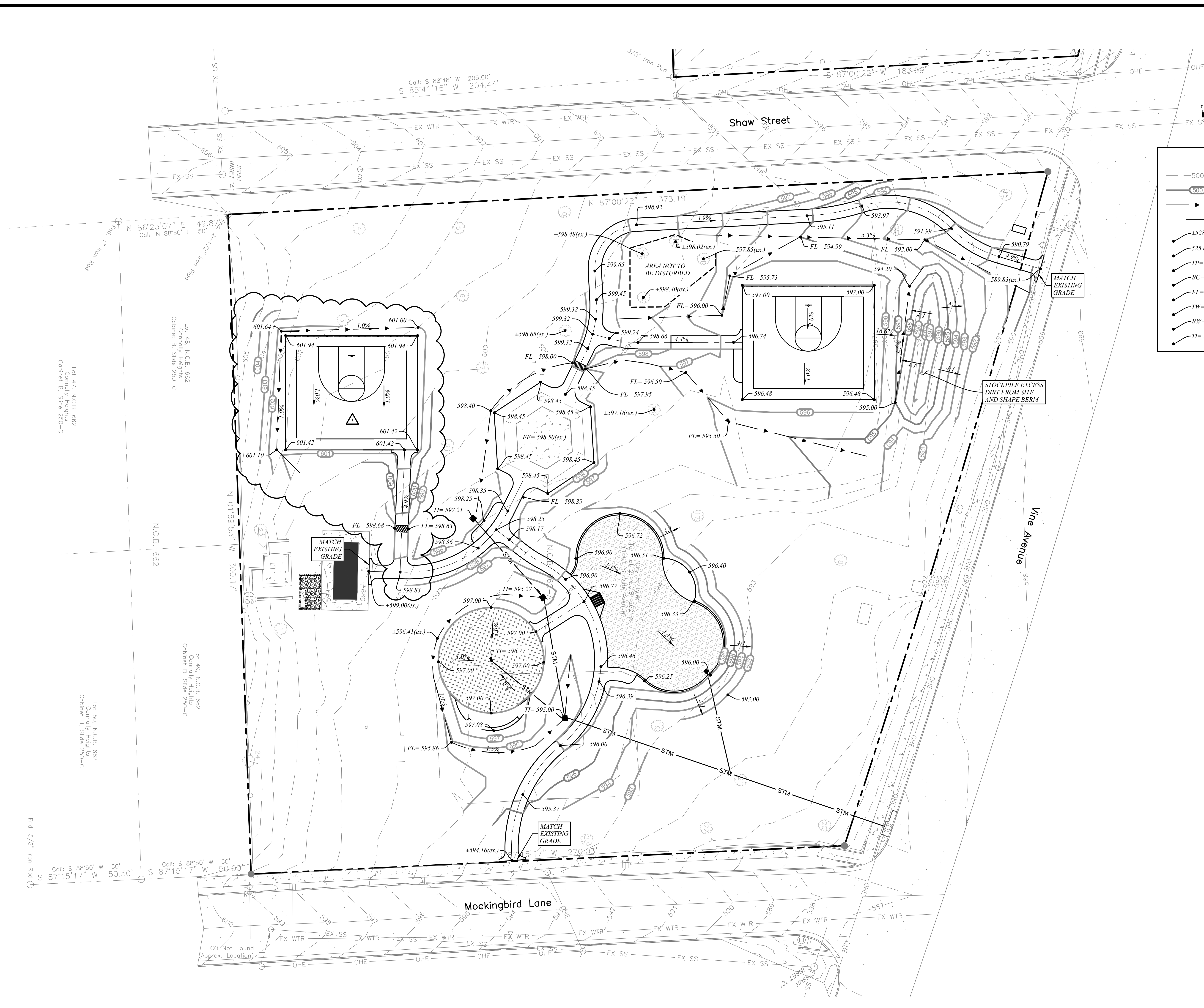

I:\city of tyler\22-069 pt.cole (cont)\CAD\03 - production\GRADING PLAN.dwg



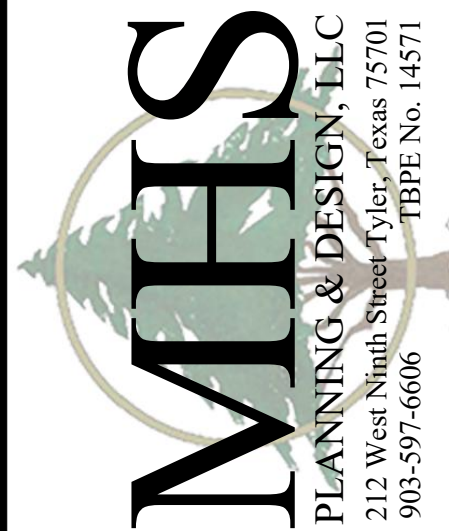
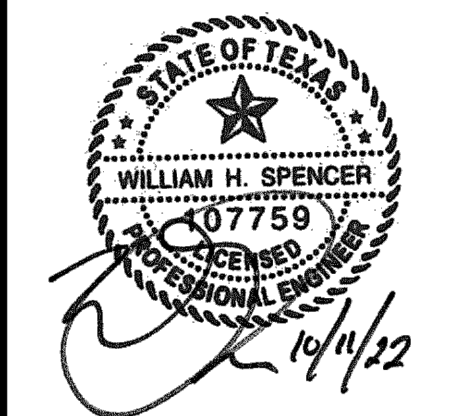

PAVING PLAN
P.T. COLE PARK
CITY OF TYLER, TEXAS

DRAWN: JHD
CHECKED: WHS
DATE: 10/25/2022
SCALE: AS SHOWN
JOB NO.: 22-069

C11

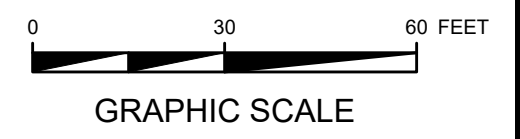
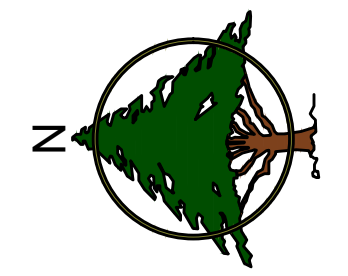

LEGEND

- 4" CONCRETE PAVEMENT ≈9,810 SF
- 6" ASPHALT PAVEMENT ≈1,573 SF
- SPLASH PAD ≈908 SF
- PLAYGROUND ≈3,248 SF
- BASKETBALL COURT
- EXPANSION JOINT
- SAW JOINT

NOTES:
ALL PAVING OPERATIONS SHALL CONFORM TO THE RECOMMENDATIONS PER THE GEOTECHNICAL REPORT (JOB #C1225107), BY TERRACON, INC. DATED OCTOBER 10TH, 2022.

CITY DETAILS TAKE PRECEDENCE IN RIGHTS OF WAY.

Parcel Line and Curve Table

Line #/Curve #	Length	Bearing/Delta	Radius
C1	25.61	29.35	50.00
C2	44.02	63.05	40.00
C3	25.35	14.52	100.00
C4	31.40	89.94	20.00
C5	25.39	29.10	50.00
C6	13.20	15.13	50.00
C7	56.69	64.96	50.00
C8	56.68	54.13	60.00
C9	37.34	42.79	50.00
C10	61.97	71.01	50.00
C11	9.40	10.78	50.00
C12	1.39	0.80	100.00
L1	19.61	N73° 49' 17.45"W	
L2	77.67	S86° 58' 48.03"W	
L3	13.12	S2° 57' 52.26"E	
L4	20.52	S26° 08' 03.92"W	
L5	47.50	N90° 00' 00.00"W	
L6	7.74	N74° 52' 25.30"W	
L7	17.17	S88° 42' 15.08"E	
L8	15.20	N26° 19' 55.80"E	
L9	2.34	N3° 08' 59.50"W	
L10	16.03	N52° 02' 33.39"W	
L11	24.61	N67° 32' 30.61"E	
L12	55.61	N1° 55' 11.01"E	

CONTROL POINT TABLE

Control Point	Northing	Easting	Elev.	Description
CP 1	6820826.188	2953768.974	598.399	1/2" IRS "Red Cap"
CP 5	6820835.552	2954073.795	587.416	1/2" IRS "Red Cap"
CP 9A	6820117.314	2953758.925	590.712	1/2" IRS "Red Cap"
CP 10A	6820478.568	2954004.487	589.279	1/2" IRS "Red Cap"
CP 11A	6820466.498	2953576.626	604.476	1/2" IRS "Red Cap"
CP 12A	6820108.670	2953572.794	598.366	1/2" IRS "Red Cap"
COT BM # T-090	6820485.929	2953904.593	591.037	City of Tyler Benchmark

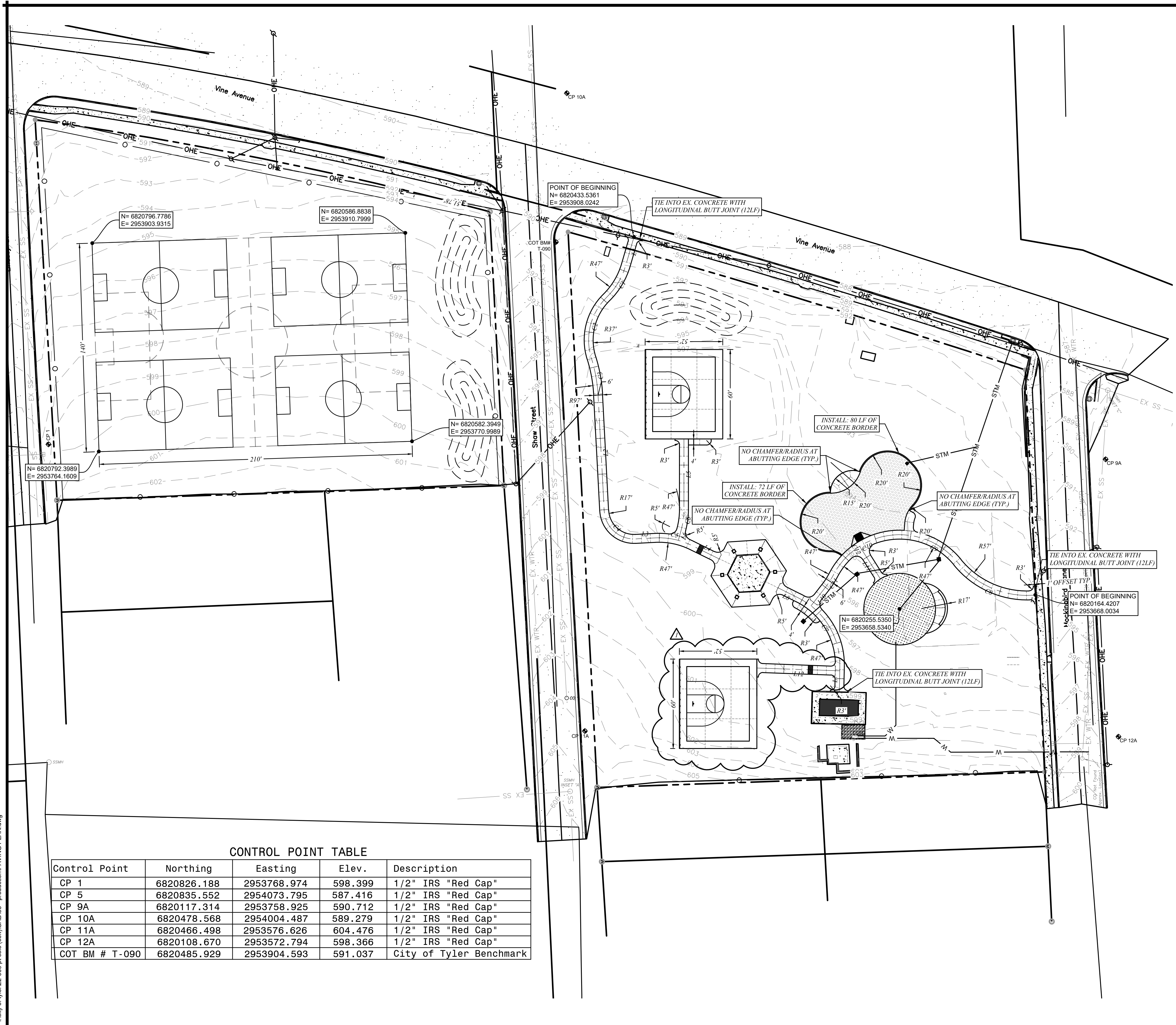

Know what's below.
Call before you dig.

Bid Proposal

Client: City of Tyler
Project: P.T. Cole Park
Sht. C1 to E3

The following bid items to include all labor, tools, equipment, superintendence, materials and any other requisite necessary to perform the work stated in accordance with the plans & specifications, complete and in place.

Item #	Quantity/Unit	Item Description & Written Price	Unit Price	Total
1	LS	Mobilize for the Project, including but not limited to project start-up and delivery of equipment _____ Dollars _____ Cents		
2	LS	Storm Water Pollution Prevention Plan and Erosion Control Elements, including but not limited to silt fencing, tree protection, inlet protection construction fencing, construction entrance and erosion control blanketing _____ Dollars _____ Cents		
3	LS	Demolition items, including but not limited to the removal and disposal of existing park lighting, basketball court and fencing, playground border, pavilion roof, equipment and surfacing, existing sidewalks, and picnic pads and existing site furniture _____ Dollars _____ Cents	By other contract	
4	LS	Rough Site Grading, including but not limited to excavation, backfill and berming _____ Dollars _____ Cents		
5	LS	Finish Site Grading, including but not limited to final grading for paving, concrete slabs, retaining walls, berming and other misc. areas _____ Dollars _____ Cents		
6	10,121 SF	4" Concrete Pavement, including but not limited to excavation, subgrade preparation, reinforcing steel, concrete, saw joints, longitudinal butt joints, and expansion joints _____ Dollars _____ Cents		

Item #	Quantity/Unit	Item Description & Written Price	Unit Price	Total
7	6,240 SF	6" Concrete Pavement for basketball court, including but not limited to excavation, subgrade preparation, reinforcing steel, concrete, saw joints, longitudinal butt joints, and expansion joints _____ Dollars _____ Cents		
8	4,200 SF	Basketball Court Plexipave surfacing and striping, per plans and specifications _____ Dollars _____ Cents		
9	1 EA	Purchase and install of Goalsetter basketball goal, per plans and specifications _____ Dollars _____ Cents		
10	120 LF	10' tall Chainlink Fencing, black posts and mesh, per plans and specifications _____ Dollars _____ Cents		
11	29,400 SF	Sodding of soccer field with Tiff Tuff Bermuda Sod, per plans and specifications _____ Dollars _____ Cents		
12	104,401 SF	Hydromulching of disturbed areas with Common Bermuda seed, per plans and specifications _____ Dollars _____ Cents		
13	3 EA	45-Gal Red Maple, including but not limited to, bed preparation, planting and warranty _____ Dollars _____ Cents		
14	2 EA	45-Gal Blackgum, including but not limited to, bed preparation, planting and warranty _____ Dollars _____ Cents		

Item #	Quantity/Unit	Item Description & Written Price	Unit Price	Total
15	4 EA	45-Gal Chinkapin Oak, including but not limited to, bed preparation, planting and warranty _____ Dollars _____ Cents		
16	3 EA	45-Gal Lacebark Elm, including but not limited to, bed preparation, planting and warranty _____ Dollars _____ Cents		
17	AL	Repair and amend existing irrigation structures as needed, per plans and specifications, included but not limited to material and labor _____ Dollars _____ Cents	\$20,000.00	\$20,000.00
18	LS	Misc. water utilites included but not limited to water lines to sprayground and equipment manifold, per plans and specifications _____ Dollars _____ Cents		
19	LS	Misc. sanitary sewer utilities, included but not limited to sanitary sewer lines from sprayground to existing infrastructure, per plans and specifications _____ Dollars _____ Cents		
20	LS	Misc. storm sewer utilities, included but not limited to site and playground drains, piping and connection to existing infrastructure, per plans and specifications _____ Dollars _____ Cents		
21	LS	Sprayground equipment enclosure, including but not limited to 6' chainlink fencing and gravel yard, per plans and specifications _____ Dollars _____ Cents		

Item #	Quantity/Unit	Item Description & Written Price	Unit Price	Total
22	LS	Pavilion renovations included but not limited to replacement of metal roofing, sub roofing, decking, any fascia, and rotten structural members. Repainting of structural members and installation of tongue and groove soffit, per plans and specifications _____ Dollars _____ Cents		
23	LS	Installation of purchased site furniture included but not limited to benches, picnic tables and trash receptacles _____ Dollars _____ Cents		
24	LS	Sidewalk slot drain, per plans and specifications _____ Dollars _____ Cents		
25	24 FFT	18"x18" Concrete Seat Wall, including but not limited to excavation, subgrade preparation, reinforcing steel, concrete, tool joints, and expansion joints, per plans and specifications _____ Dollars _____ Cents		
26	151 LF	8" Concrete playground border, per plans and specifications _____ Dollars _____ Cents		
27	1 EA	Concrete ADA playground ramp, per plans and specifications _____ Dollars _____ Cents		
28	LS	Provide and install new 100A., 120/240v., 1Ph. W.P. panelboard with main circuit breaker and branch circuit breakers as scheduled complete and in place _____ Dollars _____ Cents		

Item #	Quantity/Unit	Item Description & Written Price	Unit Price	Total
29	LS	Provide and install (2) Type 'A' pole mounted LED luminaires, poles and foundations complete and in place _____ Dollars _____ Cents		
30	LS	Provide and install (2) Type 'B' surface mounted LED luminaires complete and in place _____ Dollars _____ Cents		
31	LS	Provide and install (2) 20A., 125V., GFCI duplex receptacles in weatherproof boxes with metal in-use covers complete and in place _____ Dollars _____ Cents		
32	LS	Provide and install lighting controls, timeclocks and photocells complete and in place _____ Dollars _____ Cents		
33	LS	Coordination with Buyboard playground and sprayground providers _____ Dollars _____ Cents		
34	AL	Materials Testing and Contingency Allowance _____ \$80,000.00 _____ Dollars _____ Cents	\$80,000.00	\$80,000.00
Total Base Bid			\$ _____ Dollars _____ Cents	

Bid Alternates				
Item #	Quantity/Unit	Item Description & Written Price	Unit Price	Total
1	732 LF	Removal and replacement of existing 2"x2" chainlink mesh fencing, repaint existing posts, per plans and specifications _____ Dollars _____ Cents		
2	LS	Superior Shade 10'x25' shade sail, per plans and specifications _____ Dollars _____ Cents		
3	LS	Additional playground elements, per plans and specifications _____ Dollars _____ Cents		
Total Bid Alternate			\$ _____ Dollars _____ Cents	