

ORDINANCE NO. O-2018-58

AN ORDINANCE OF THE CITY COUNCIL OF THE CITY OF TYLER, TEXAS, PROVIDING FOR THE CLOSURE OF AN UNPAVED PORTION OF ROWLAND PLACE. THE WEST SIDE AND EAST SIDE OF THE RIGHT-OF-WAY IS ADJACENT TO TIMBERWILDE DRIVE. THE NORTH SIDE IS ADJACENT TO LOT 1A OF NCB 999R. THE SOUTH SIDE IS ADJACENT TO LOT 23C OF NCB 999N; PROVIDING FOR THE TERMS AND CONDITIONS OF SUCH CLOSURE; PROVIDING A SEVERABILITY CLAUSE; AND ESTABLISHING AN EFFECTIVE DATE.

WHEREAS, the applicant is requesting the closure in order to replat a portion of right-of-way into the south adjacent property. The west side and east side of the right-of-way is adjacent to Timberwilde Drive. The north side is adjacent to Lot 1A of NCB 999R. The south side is adjacent to Lot 23C of NCB 999N;

NOW, THEREFORE, BE IT ORDAINED BY THE CITY COUNCIL OF THE CITY OF TYLER, TEXAS:

PART 1: That the following thoroughfare closure is hereby approved as follows:

I. APPLICATION C18-003

That the public right-of-way described below, and the same is hereby abandoned, vacated and closed insofar as the right, or title of the public is concerned:

PART 4: That the abandonment provided for herein shall extend only to the public right, title and overlay with ingress/egress, public utility easements and to the tracts of land described in this ordinance, and shall be construed only to that interest that the governing body of the City of Tyler may legally and lawfully abandon.

PART 5: Should any section, subsection, sentence, provision, clause or phrase be held to be invalid for any reason, such holding shall not render invalid any other section, subsection, sentence, provision, clause or phrase of this ordinance and same are deemed severable for this purpose.

PART 6: That this ordinance shall be effective on and after its date of passage and approval by the City Council.

PASSED AND APPROVED this the 25th day of July A.D., 2018.

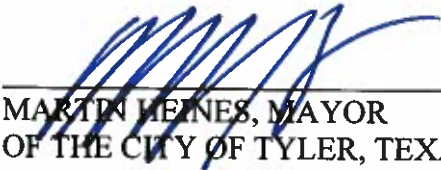

MARTIN HEINES, MAYOR
OF THE CITY OF TYLER, TEXAS

ATTEST:

APPROVED:

CASSANDRA BRAGER, CITY CLERK



SHARON F. ROBERTS,
SR. ASSISTANT CITY ATTORNEY

ORDINANCE NO. O-2018-58
EXHIBIT "A"
LOCATION MAP



This product is for informational purposes and may not have been prepared for or be suitable for legal, engineering, or surveying purposes. It does not represent an on-the-ground survey and represents only the approximate relative location of property boundaries.

200 0 200 Feet

THOROUGHFARE CLOSURE
Closure Case #: C18-003
Thoroughfare Name: Timberwilde Drive
Applicant: Clint James

Subject Property

**ORDINANCE NO. O-2018-58
EXHIBIT "B"
NOTIFICATION MAP**

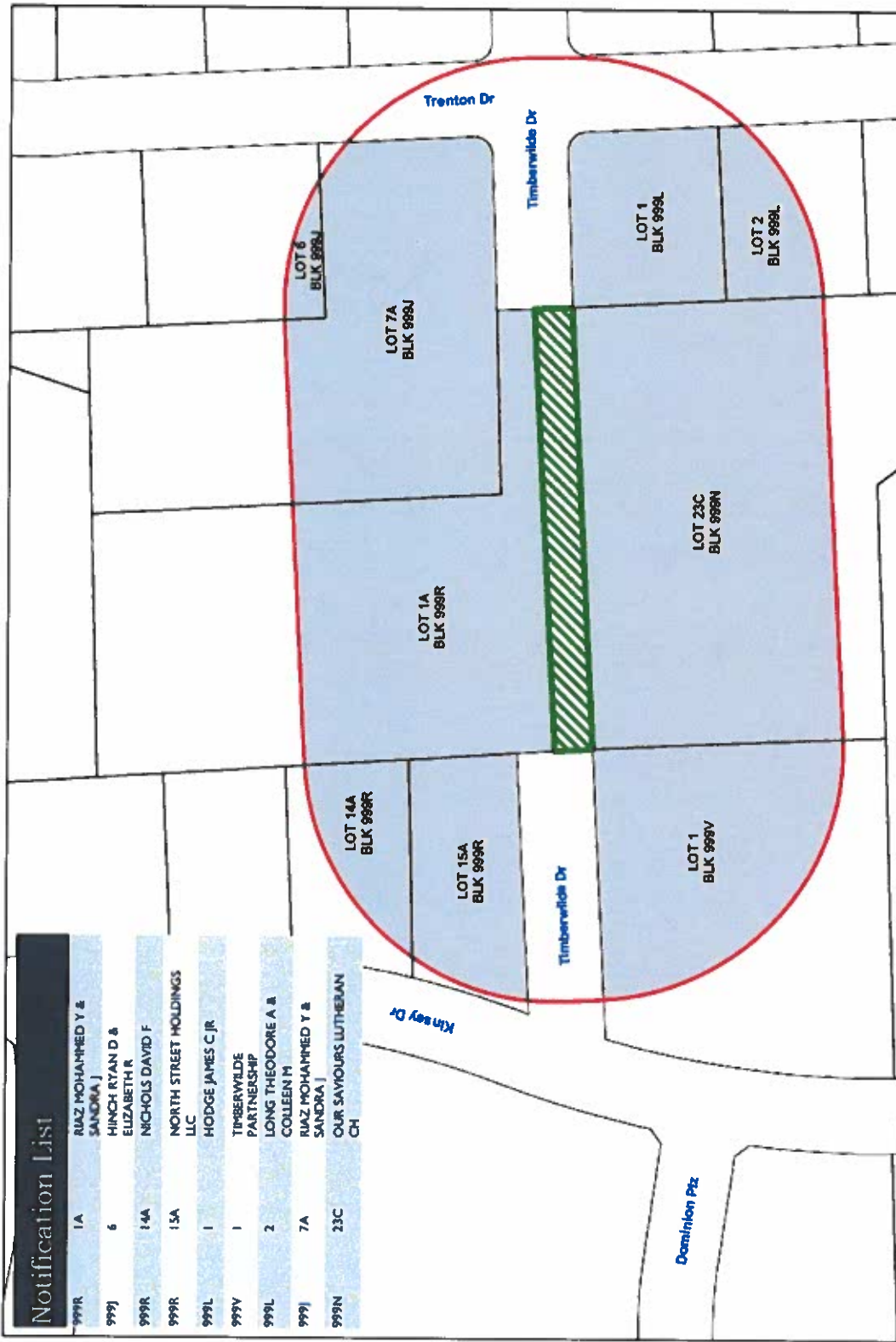

Notification List

999R	1A	RAZ MOHAMMED Y & SANDRA J
999J	6	HINCH RYAN D & ELIZABETH R
999R	14A	NICHOLS DAVID F
999R	15A	NORTH STREET HOLDINGS LLC
999L	1	HODGE JAMES C JR
999V	1	TIMBERWILDE PARTNERSHIP
999L	2	LONG THEODORE A & COLLEEN M
999J	7A	RAZ MOHAMMED Y & SANDRA J
999N	23C	OUR SAVOIRS LUTHERAN CH

This product is for informational purposes and may not have been prepared for use in a legal proceeding or for legal engineering or surveying purposes. It does not represent an official survey and represents only the approximate relative location of property boundaries.

100 0 100 Feet

THOROUGHFARE CLOSURE
Closure Case #: C18-003
Thoroughfare Name: Timberwilde Drive
Applicant: Clint James

 Subject Property
200' Notification Buffer

